

- 57 - 10X10\_MAX BOOTHS = 5700 SQ.FT.
- 1 - 10X19 BOOTHS = 190 SQ.FT.
- 66 - 10X20 BOOTHS = 13200 SQ.FT.
- 2 - 10X9 BOOTHS = 180 SQ.FT.
- 4 - 20X19 BOOTHS = 1520 SQ.FT.
- 57 - 20X20 BOOTHS = 22800 SQ.FT.
- 2 - 20X29 BOOTHS = 1160 SQ.FT.
- 8 - 20X30 BOOTHS = 4800 SQ.FT.
- 3 - 20X39 BOOTHS = 2340 SQ.FT.
- 3 - 20X40 BOOTHS = 2400 SQ.FT.
- 1 - 20X49 BOOTHS = 980 SQ.FT.
- 1 - 20X88 BOOTHS = 1760 SQ.FT.
- 2 - 20X9 BOOTHS = 360 SQ.FT.
- 2 - 25X60 BOOTHS = 3000 SQ.FT.
- 4 - 30X29 BOOTHS = 3480 SQ.FT.
- 8 - 30X30 BOOTHS = 7200 SQ.FT.
- 1 - 30X39 BOOTHS = 1170 SQ.FT.
- 3 - 30X40 BOOTHS = 3600 SQ.FT.
- 3 - 30X50 BOOTHS = 4500 SQ.FT.
- 1 - 30X60 BOOTHS = 1800 SQ.FT.
- 2 - 40X39 BOOTHS = 3120 SQ.FT.
- 7 - 40X40 BOOTHS = 11200 SQ.FT.
- 1 - 50X29 BOOTHS = 1450 SQ.FT.
- 3 - 50X50 BOOTHS = 7500 SQ.FT.
- TOTAL SQUARE FOOTAGE: 105410 SQ.FT.

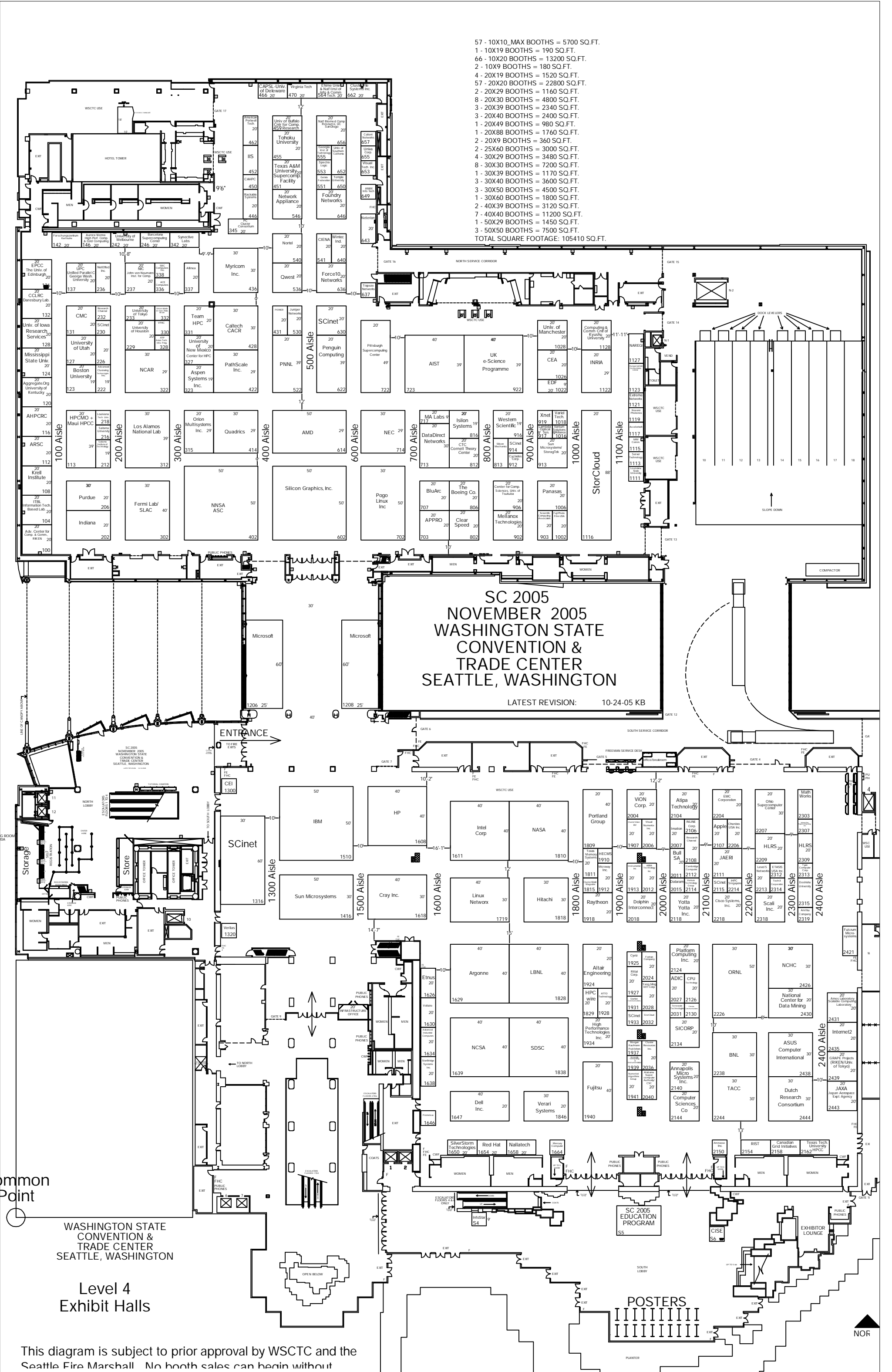

ommon Point  
 WASHINGTON STATE CONVENTION & TRADE CENTER SEATTLE, WASHINGTON

Level 4 Exhibit Halls

This diagram is subject to prior approval by WSCTC and the Seattle Fire Marshall. No booth sales can begin without

